

# Exterior Cable (Wire)

## Guide Shade

Installation

**Nice**

## Contents

<b>SECTION A - TOOLS AND ADDITIONAL ITEMS REQUIRED .....</b>	<b>3</b>
PART A – TOOLS REQUIRED.....	3
PART B – ADDITIONAL ITEMS REQUIRED (NOT SUPPLIED).....	3
PART C – BLIND ITEMS REQUIRED.....	3
 <b>SECTION B - INSTALLATION.....</b>	 <b>5</b>
PART A - CHECK FOR OBSTRUCTIONS .....	5
PART B - CHECK VERTICAL & HORIZONTAL INSTALLATION DIMENSIONS .....	6
PART C - OPEN BRACKET INSTALLATION.....	7
PART D - BLIND INSTALLATION.....	8
PART E - TENSIONS GUIDELINES .....	12
 <b>SECTION C - TROUBLESHOOTING .....</b>	 <b>16</b>
 <b>NOTES .....</b>	 <b>17</b>

## Section A - Tools and additional items required

### PART A – TOOLS REQUIRED

- a) Saw
- b) Drill
- c) Screwdriver – Philips Head & Flat Head
- d) Jaw Pliers
- e) Allen Key Set
- f) Mallet
- g) Scissors
- h) Measuring Tape
- i) Pencil

### PART B – ADDITIONAL ITEMS REQUIRED (NOT SUPPLIED)

To assemble an Evo | Wire Guide, the following non-stocked items are required:

- j) Fixings for Box/Open Brackets/Hardware (ensure appropriate fixings are used to suit application)
- k) Trims to conceal packing (if required)

### PART C – BLIND ITEMS REQUIRED

Box

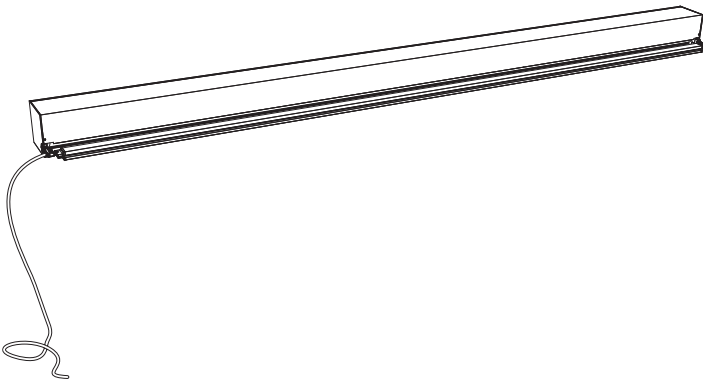

Open Brackets

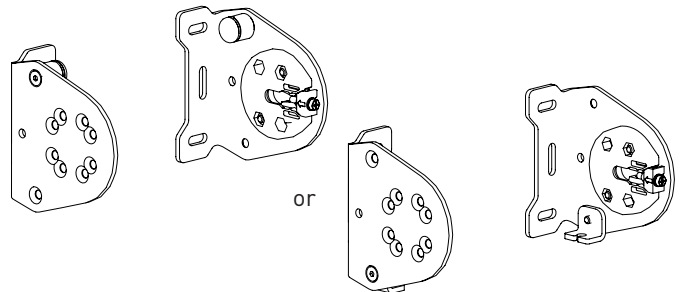

**Note:** Store clip until required (can be left in adaptor as shown)

Blind

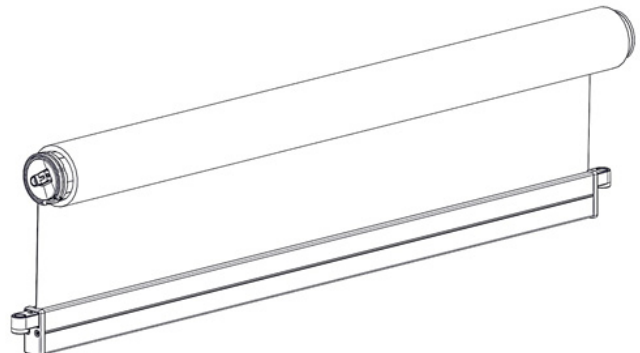

### PART C – BLIND ITEMS REQUIRED

Hook Terminal

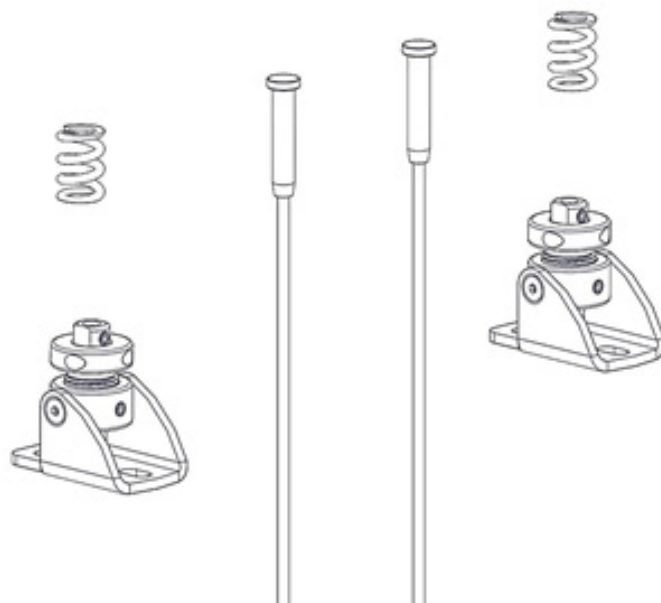

### PART A - CHECK FOR OBSTRUCTIONS

#### STEP 1 – TOOLS REQUIRED

Check for any obstructions that may interfere in installation.

#### STEP 2 - CHECK VERTICAL & HORIZONTAL INSTALLATION DIMENSIONS

Vertical Dimensions

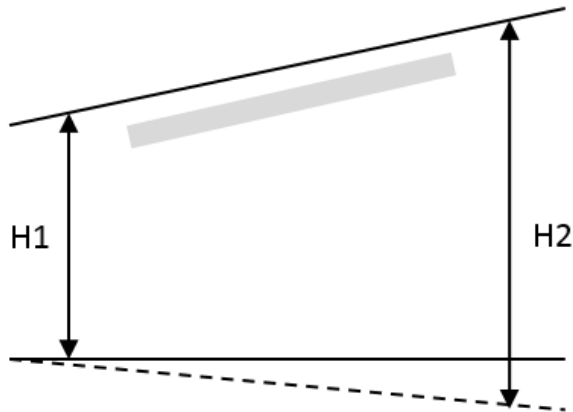

Check if top of installation space is level.

- If  $H1 \neq H2$ , corrective actions may need to be considered prior to installation.

Horizontal Dimensions

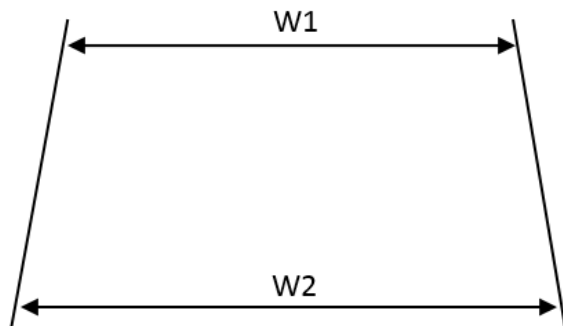

- If  $W2 \geq W1$ ,  $W1$ =Blind Width (proceed to Part B)

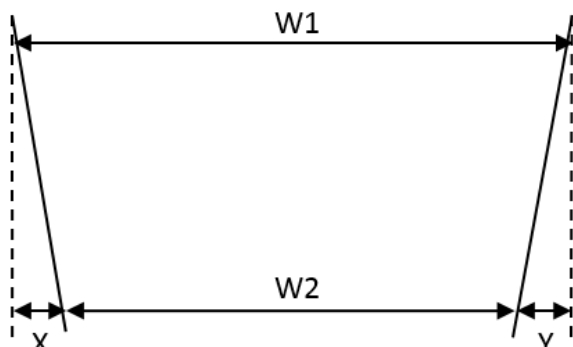

- If  $W2 < W1$ , by a value of:
- 0-20mm, Proceed to Part B ( $W1$  = Blind Width)
- 20+, Consider corrective action to square installation space.

### PART B - CHECK VERTICAL & HORIZONTAL INSTALLATION DIMENSIONS

#### STEP 1 - REMOVE SHADE ROLLER FROM BOX

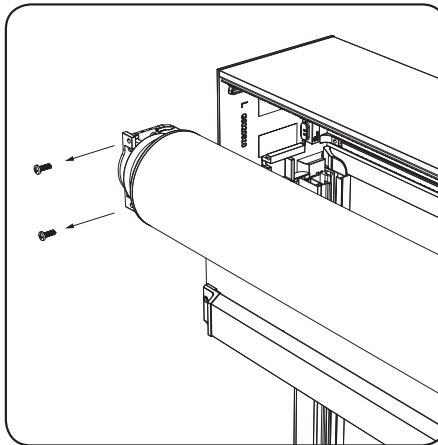
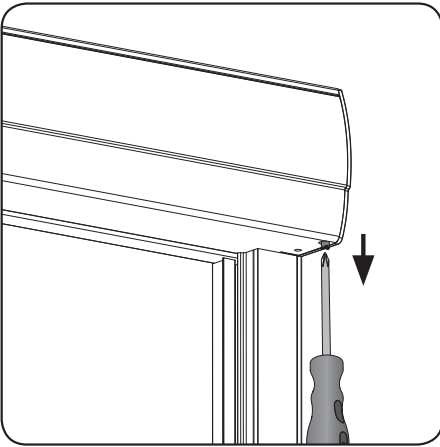

Remove 2 pan-head Philips screws from underside of head box, take off cover extrusion and place to the side. Then remove 2 pan-head Philips screws from each side (the motor and idler side) as shown in the left image. Finally, pull the fabric roller out - the idler side slides easily however the motor side might take some force.

#### STEP 2 - INSTALL BOX TO WALL OR CEILING

Through Rear Face

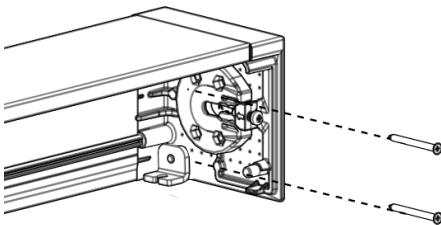

Through Side Caps

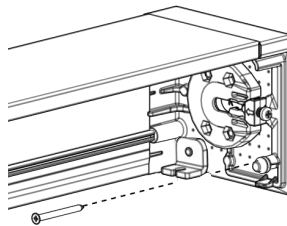

Through Top Face

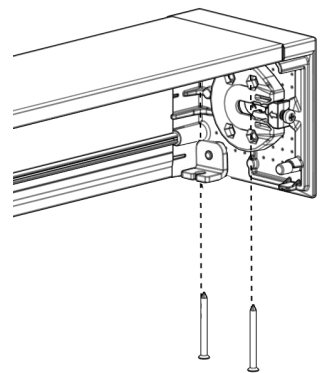

Run screws through either the face, the side end caps (be careful not to interfere with the idler or motor sliding brackets) or the top. These screws are not supplied as there are many different substrates to mount to and all of which require their own specific fasteners.

### PART C - OPEN BRACKET INSTALLATION

#### STEP 1 - INSTALL BRACKETS TO WALL OR CEILING

Face Fix

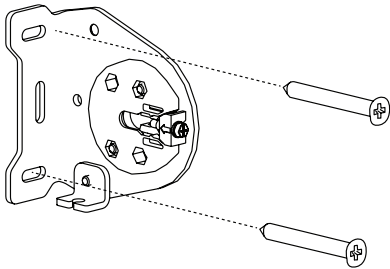

Side Fix

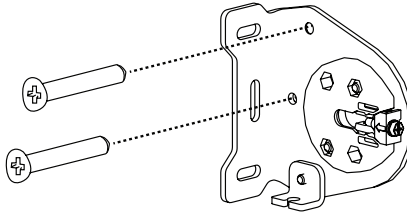

Top Fix

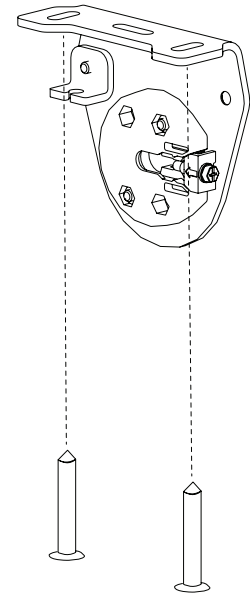

#### Note

Use appropriate fixings to suit application. Ensure 2 fasteners are used per side. Ensure brackets are aligned and level.  
Measure brackets end to end to confirm measurement is correct.

### PART D - BLIND INSTALLATION

#### STEP 1 - MARK AND SECURE WIRE GUIDE FIXINGS AND TRIM WIRE TO SUIT

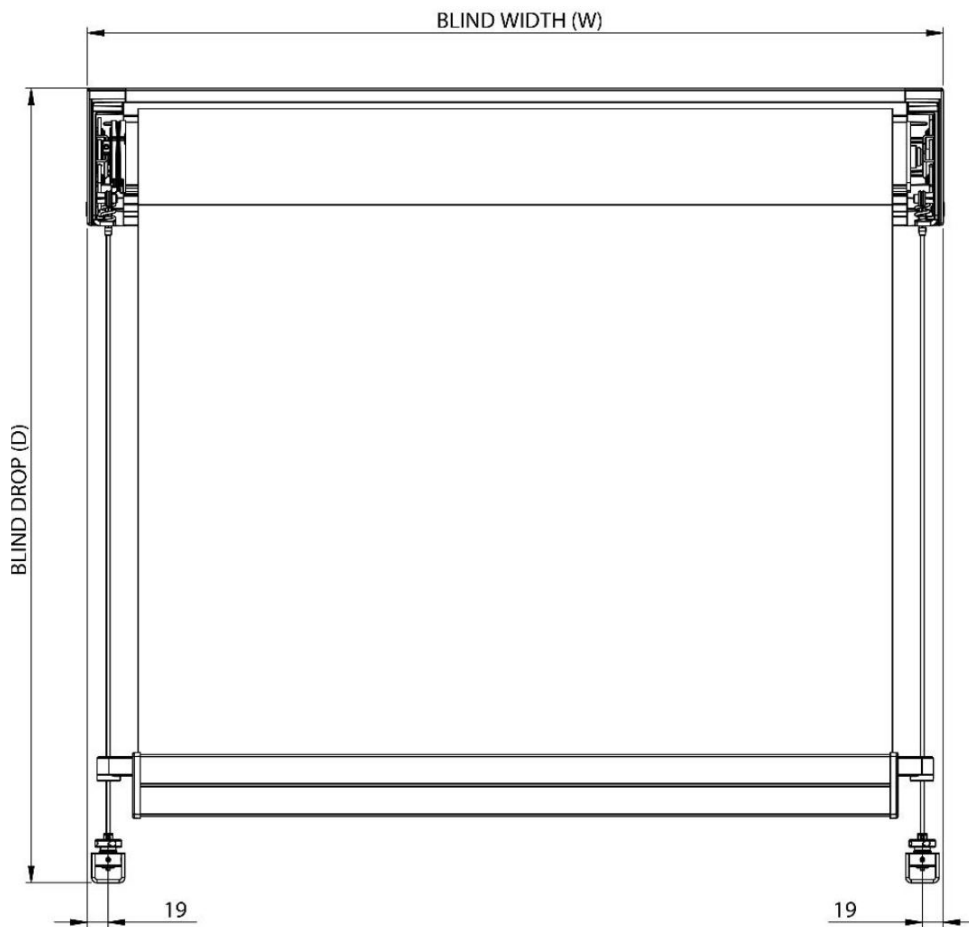

#### WIRE CENTRES

BOX	19mm
OPEN	18mm

#### Note

Cut wire to assist installation (ensure wire is not cut too short, excess can be trimmed later).



### PART D - BLIND INSTALLATION

Floor Fix



Face/Side Fix

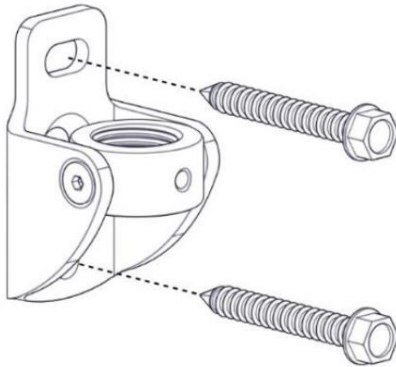

Floor Fix  
(optional for securing  
to masonry)

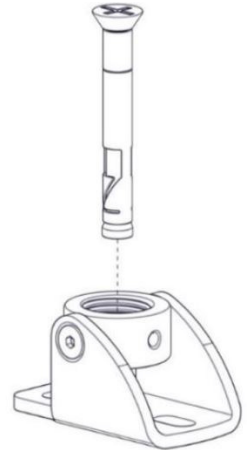

#### Note

Ensure fasteners suit substrate application Max fastener size #10,  
Max Dynabolt Size: M6.

### STEP 2 - (OPTIONAL) INSERT SPRING ONTO WIRE OR STUD

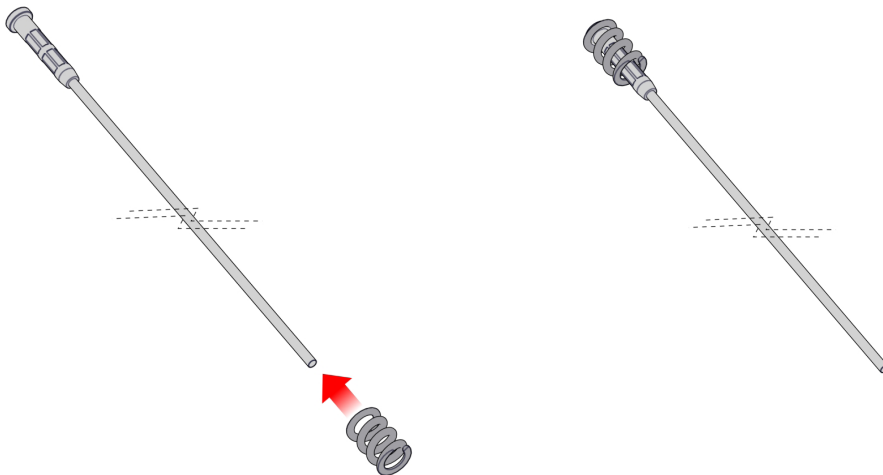

### PART D - BLIND INSTALLATION

#### STEP 3 - ATTACH WIRE TO L-BRACKET

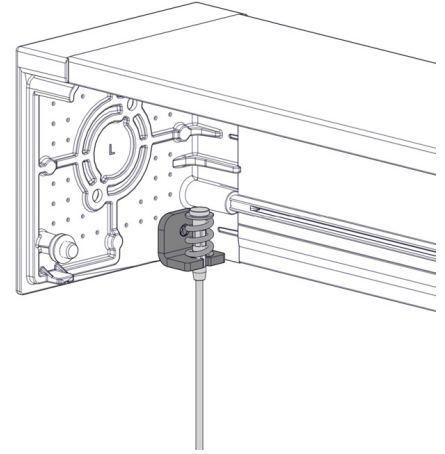
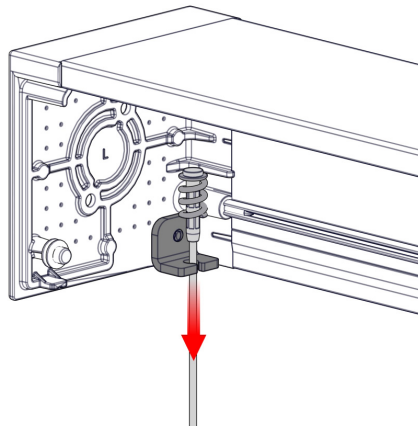
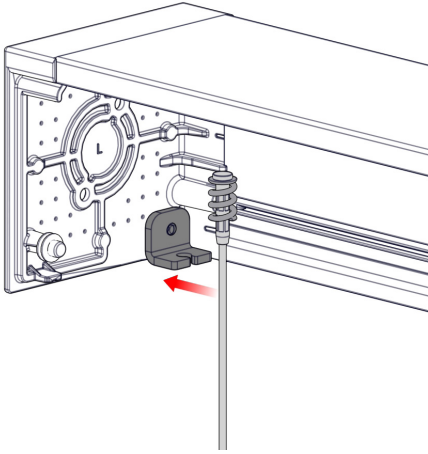

#### Note:

Tube hardware not shown for clarity of wire installation.

#### STEP 4 - INSERT BLIND INTO BOX

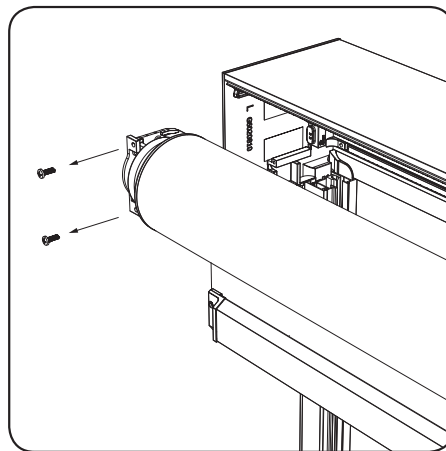

#### Note:

Insert fabric roller back into head box. Again, the idler side will slide in smoothly but the motor side will require some force. Then re-install the 4 pan head Philips screws.

### PART D - BLIND INSTALLATION

#### STEP 5 - INSERT WIRE THROUGH WEIGHT BAR END CAP FLOATS

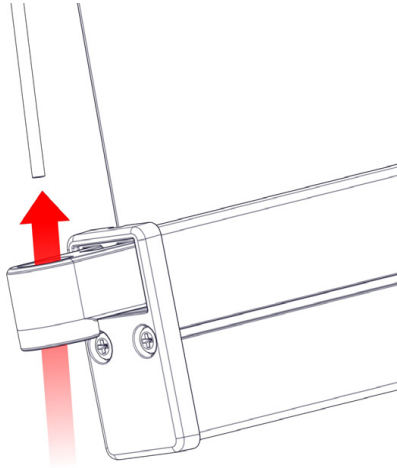

#### STEP 6 - TEST BLIND OPERATION

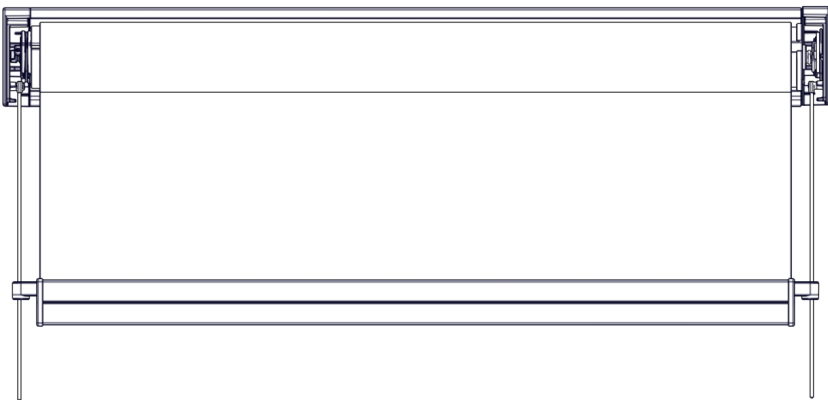

##### For Motorized Shades

See separate instructions to walk you through the pairing and programming of motors to controls.

### PART E - TENSIONS GUIDELINES

#### STEP 1 - SWING BOX COVER INTO BOX TOP AND CLIP INTO PLACE

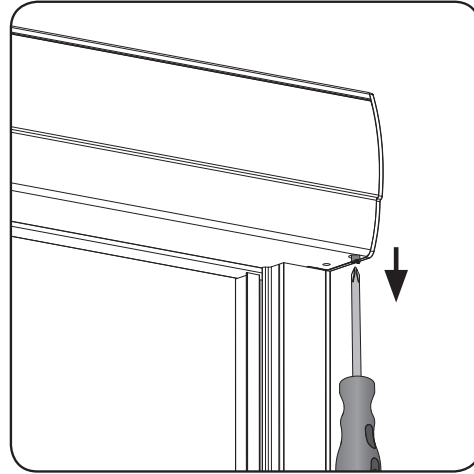
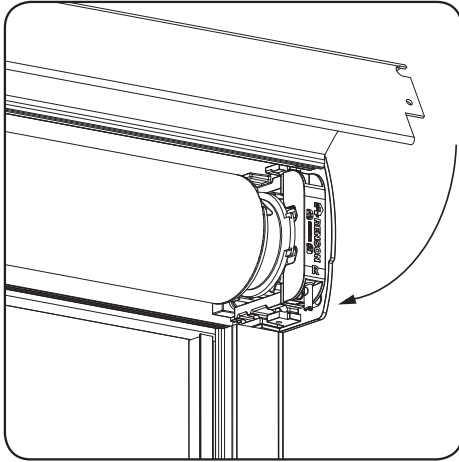

#### STEP 2 - PULL WIRE STRAIGHT AND ALIGN TERMINAL FLANGE WITH M4 GRUB SCREW, CLAMP TO WIRE

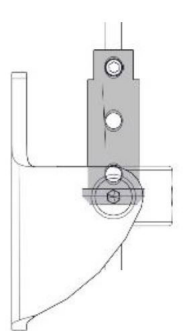
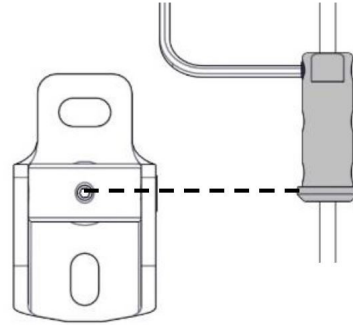
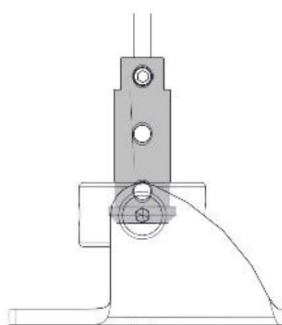
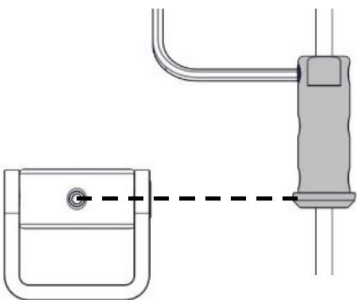

### PART E - TENSIONS GUIDELINES

#### STEP 3 - TIGHTEN REMAINING GRUB SCREWS ON WIRE (TIGHTEN 3X SCREWS PER WIRE)

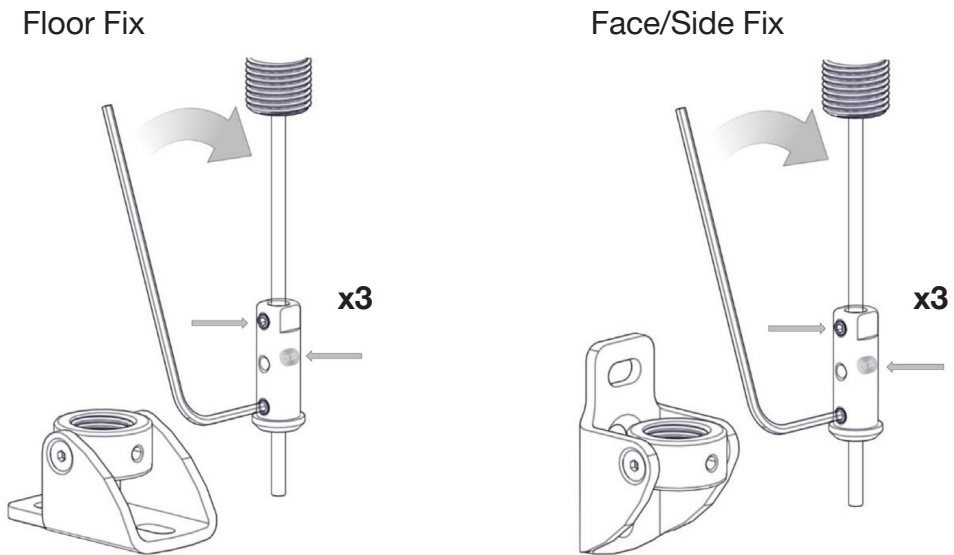

#### Note

Use 2mm Allen Key.

#### STEP 4 - LOWER ADJUSTING SLEEVE INTO COLLAR TO TENSION WIRE

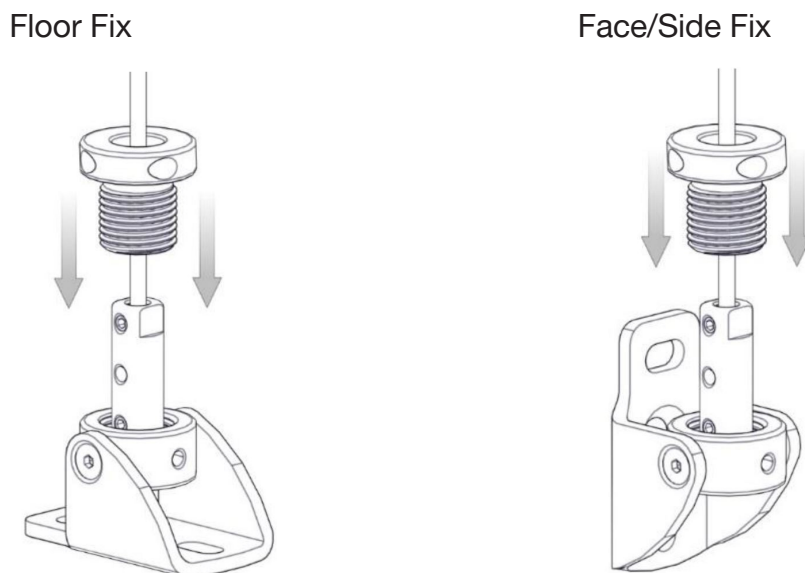

### PART E - TENSIONS GUIDELINES

#### STEP 5 - SCREW IN ADJUSTING SLEEVE UNTIL WIRE BEGINS TO TENSION

Floor Fix

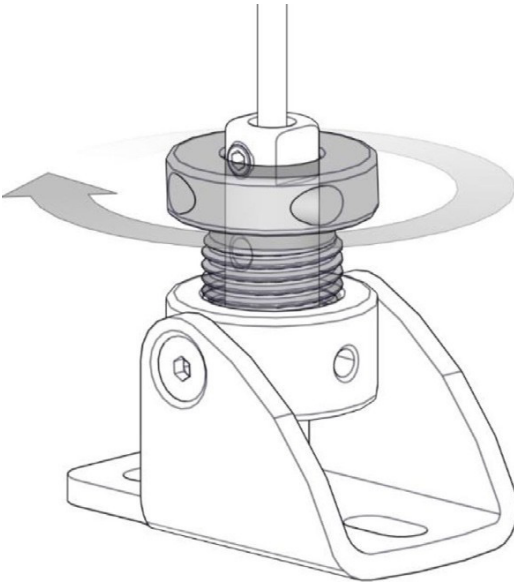

Face/Side Fix

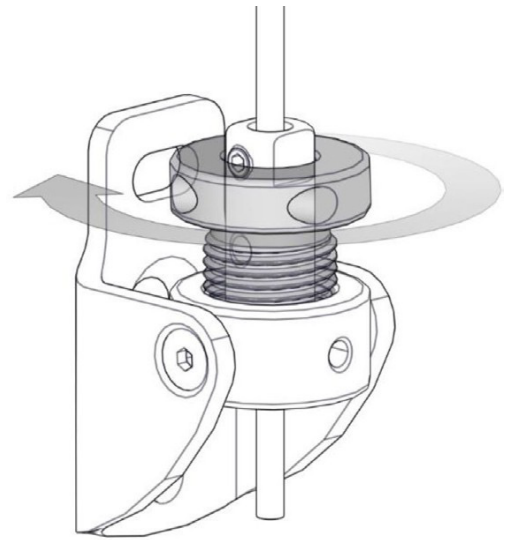

#### STEP 6 - TO APPLY MIN REQUIRED TENSION, TIGHTEN WITH 5X TURNS USING ALLEN KEY

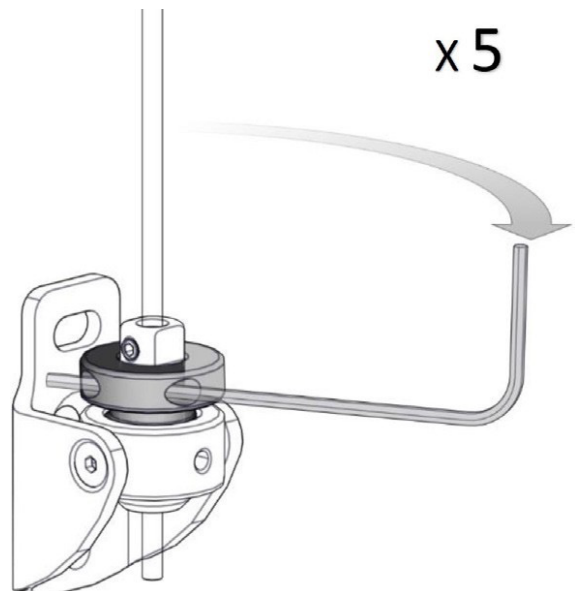
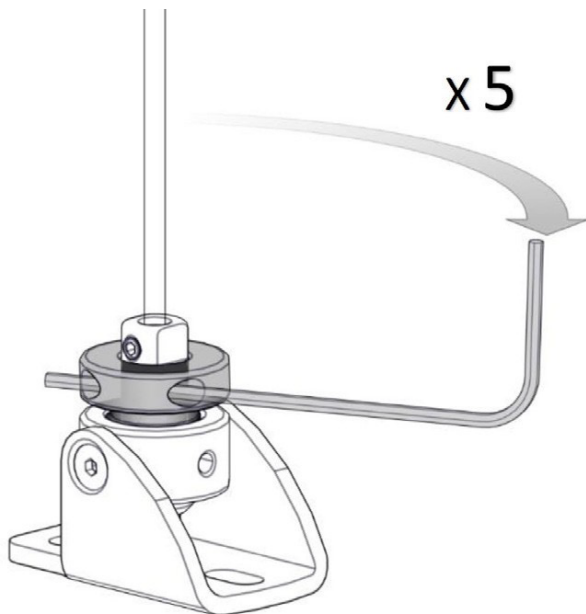

### PART E - TENSIONS GUIDELINES

#### STEP 7 - ONCE TENSIONED, SCREW IN GRUB SCREW TO PREVENT LOSING TENSION

Floor Fix

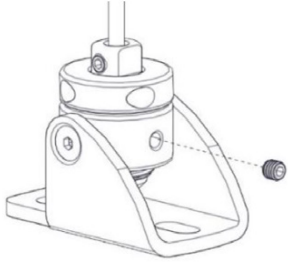

Face/Side Fix

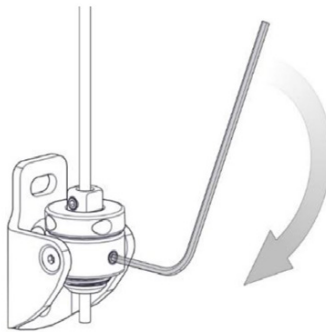
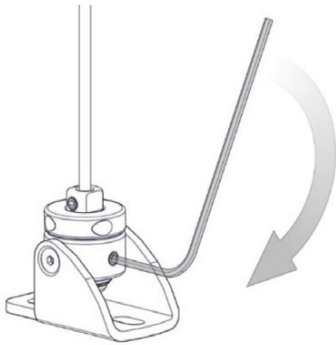
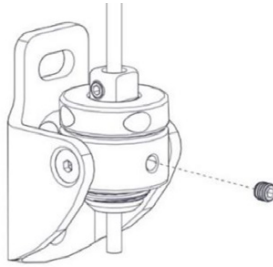

#### Note

Use 2mm Allen Key.

## Section C - Troubleshooting

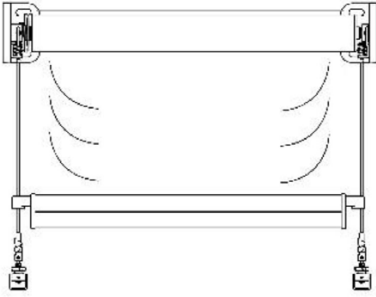
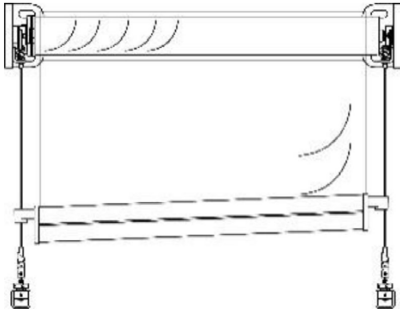
NO	PROBLEM	CAUSE	SOLUTION
1	<p>Ripples along side of fabric</p> 	Blind rolled up for an extended period of time.	This occurrence is inherent to roller systems and is more prevalent in some fabrics. Leave blind down for 1 – 4 hours; most ripples should disappear.
		Not enough weight in weight bar.	Refer to Product Specs. Add ballast.
		Installation is not square.	Check blind roll is installed level.
		Fabric permanently damaged due to inadequate handling during assembly, transportation, installation or use.	Replace fabric and ensure it is handled with care.
2	Blind does not fully open / jams	Position of wire guides at base is incorrect.	Check if wire guide fixing at floor/ base are positioned in line with the Top Terminal. If fixing is too far inwards of the terminal then reposition. Refer to Part C, Step 1 of this document for wire guide positioning details.
		Incorrect motor stop limits used.	Refer to motor instructions to reset stop limits.
3	<p>Ripples along side of fabric</p> 	Blind roll is not level, thus weight bar appears uneven.	Ensure blind is installed level.
		Blind has been operated in excessive wind conditions.	Check blind roll when the blind is fully raised. If ripples are evident on roll, open blind fully (without the presence of wind) to allow the blind to track down evenly. Raise and lower blind a number of times to check operation.
		Fabric is not installed straight.	Ensure fabric is assembled straight onto tube and weight bar.



## Notes

## Technical Support

760-438-7000  
Monday–Friday, 6:00 a.m. – 4:00 p.m. PST

## Nice North America

c/o Customer Service  
5919 Sea Otter Place, Ste. 100  
Carlsbad, CA 92010

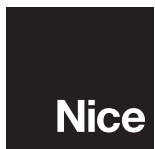

**Niceforyou.com**