

Sun Shade



Dual Fascia

Installation

Nice

Dual Roller with Fascia Bracket Installation

Tools Needed

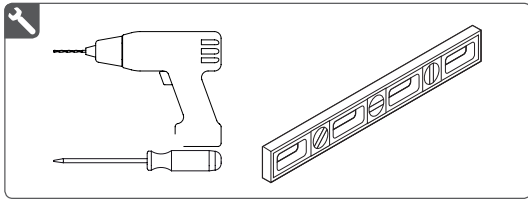

IDLER END BRACKET

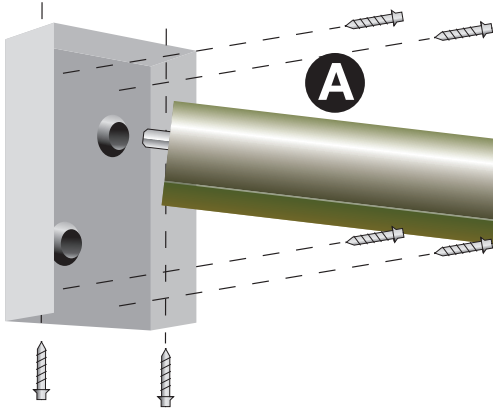

MOTOR END BRACKET

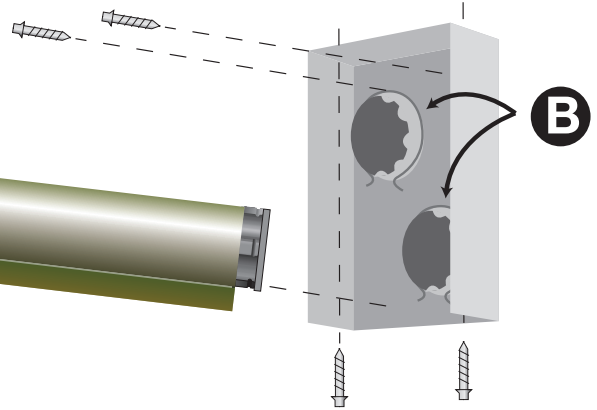

A. Insert the Idler End of the shade.

B. Insert the Motor End: Remove lock ring prior to inserting the Motor End of shade. Re-install the Lock Ring after the shade is fully assembled into the bracket.

C. Snap on Fascia Panel: Hook the Fascia to top of the brackets, then snap in bottom edge.

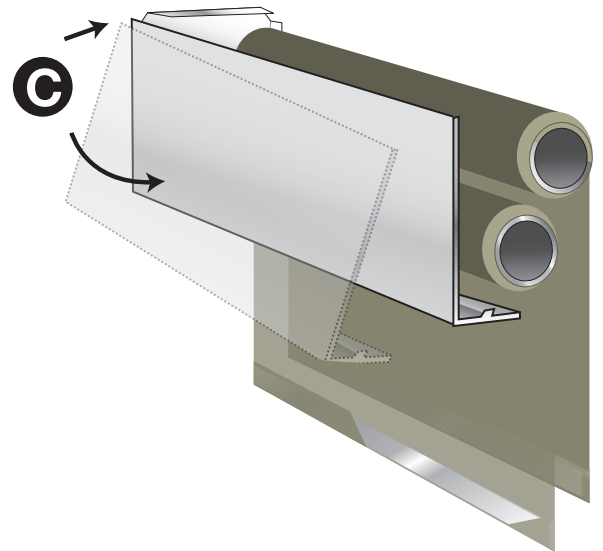

Nice

Niceforyou.com

©2023 Nice North America LLC.
All rights reserved.

Technical Support:
800-421-1587

Technical Support Hours:
M – F, 6am – 4pm PST

Nice North America
c/o Customer Service
5919 Sea Otter Place, Ste. 100
Carlsbad, CA 92010

10033836 Rev-A