

LOAD SENSING ADJUSTMENT

THIS MODEL INCORPORATES A LOAD-SENSING FEATURE IN THE OPEN DIRECTION. IF THE GRILLE/GATE IS OBSTRUCTED OR LOCKED WHILE OPENING THEN THE LOAD-SENSING FEATURE WILL ACTIVATE AND STOP GRILLE/GATE MOVEMENT. UPON ACTIVATION OF LOAD-SENSING FEATURE, YOU MUST INITIATE A CLOSE COMMAND TO RESET THE SYSTEM.

NOTE: SPRING TENSION ADJUSTMENT WING NUT MUST BE ADJUSTED PER INSTALLATION, FACTORY ADJUSTMENT IS STRICTLY FOR OPERATOR TESTING ONLY.

ADJUSTMENT CONDITIONS

1. FOR LARGER OR HEAVIER GRILLES/GATES
IF GRILLE/GATE EXPERIENCES A JERKING MOTION DURING OPENING DIRECTION, OR WILL NOT INITIATE OPEN MOTION AT ALL, THEN TURN WING NUT ON SPRING TENSION ADJUSTMENT ROD CLOCKWISE (ONE TURN AT A TIME). THIS INCREASES SPRING TENSION ON LOAD SENSING FEATURE TO BE LESS SENSITIVE.
2. FOR SMALLER/LIGHTER GRILLES/GATES
IF GRILLE/GATE WILL NOT RESPOND BY WAY OF THE LOAD SENSING FEATURE THEN IT MAY BE NECESSARY TO TURN WING NUT ON SPRING TENSION ADJUSTMENT ROD COUNTER-CLOCKWISE (ONE TURN AT A TIME). THIS DECREASES SPRING TENSION ON LOAD SENSING FEATURE TO BE MORE SENSITIVE.
3. CHAIN TENSION STOP BOLT
THIS IS A PRE-SET FACTORY SETTING THAT LIMITS THE MOVEMENT OF THE LOAD SENSING BRACKET AND SHOULD NOT BE ADJUSTED.
4. LIMIT SWITCH ACTIVATION BOLT
THIS BOLT RAISES OR LOWERS THE LOAD SENSING LIMIT SWITCH ACTIVATION POINT. THIS ASSEMBLY IS ADJUSTED AT FACTORY AND SHOULD NOT NEED TO BE ADJUSTED IN THE FIELD.

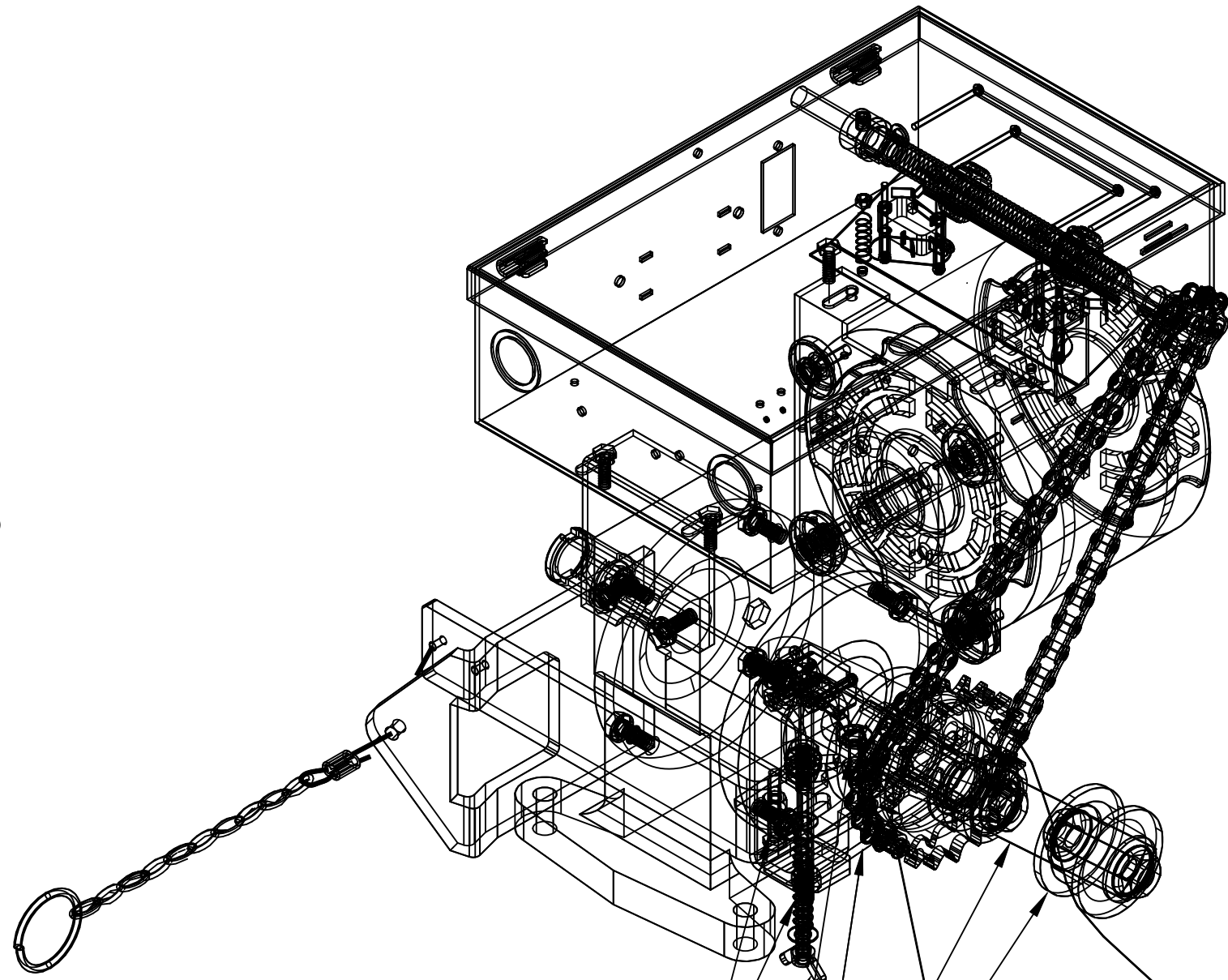

- CHAIN TENSION STOP BOLT
- SPRING TENSION ADJUSTMENT ROD
- WING NUT
- LIMIT SWITCH ACTIVATION BOLT
- LOAD SENSING BRACKET
- IDLER
- DRIVE CHAIN
- DOOR SPROCKET

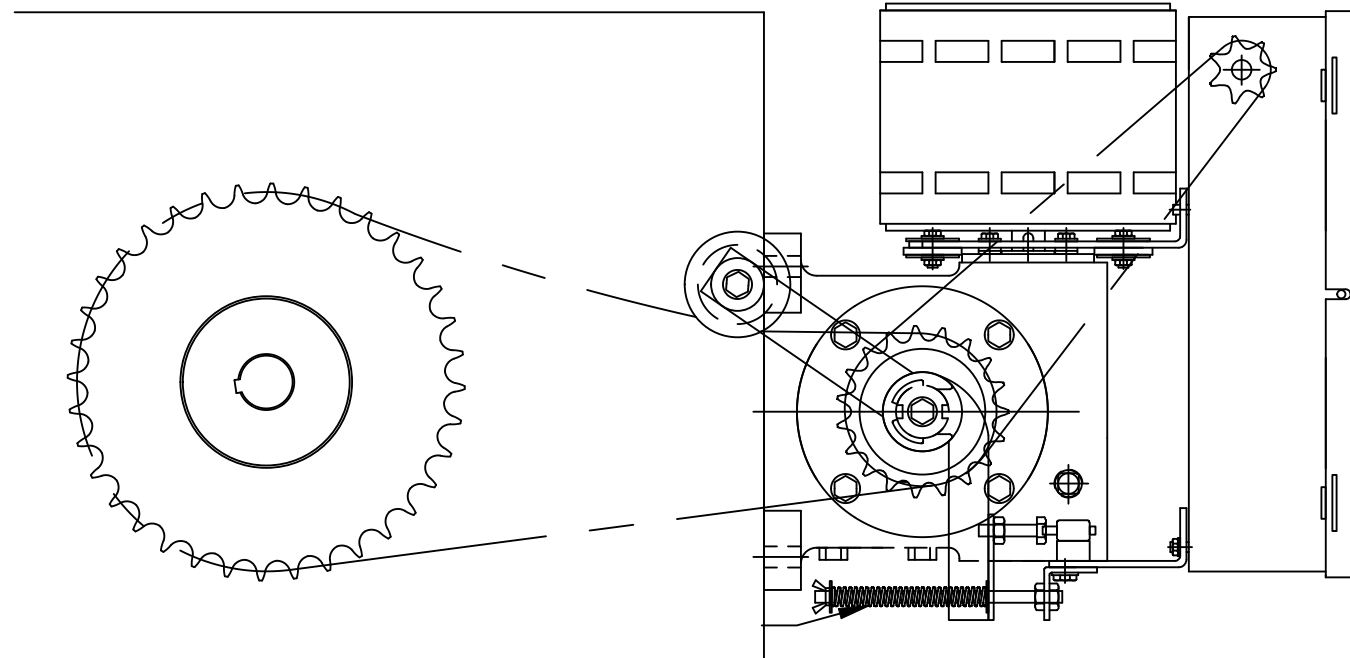

04.09.08	C.S.	D.J.	NICE GROUP CANADA INC.		
DATE:	APPROVED:	DRAWN BY:	TITLE		
UNLESS OTHERWISE SPECIFIED DIMENSIONS ARE IN INCHES TOLERANCES .XX=±.01 ANGLES=±30'			PRO-GJ LOAD SENSING ADJUSTMENT INSTRUCTIONS		
MATERIAL		WEIGHT	SIZE		
		lb	A		
REVISION: A			CAD FILE: PROGJ-LOAD SENSING	SCALE: 2:5	PAGE 1/1